

THE
NEW ORLEANS
BARNETT

POWER ER FUL

16,000 square feet of indoor and outdoor space awaits at The Barnett in New Orleans' Warehouse District. Historic charm blends with modern design and upgraded event technology throughout each of our venues, with each offering their own unique atmosphere—from our greenery-covered courtyard and garden rooftop to our original cobblestone reception area and performance-ready music rooms.

Plan your next meeting, special event or social gathering at The Barnett and join the chorus of New Orleans' vibrant song.



jd
v
BY HYATT™



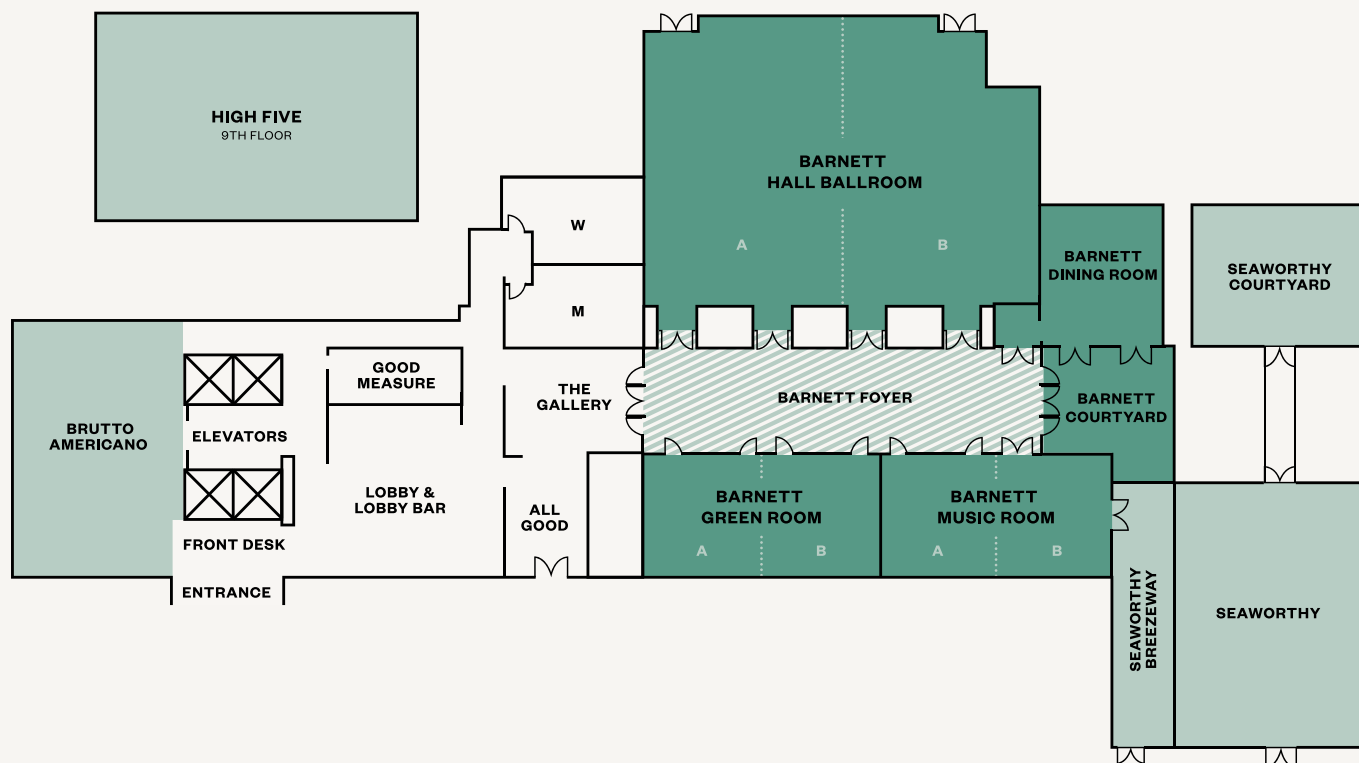

ROOM NAME	DIMENSIONS	CEILING HEIGHT	SQ FT	CAPACITY	U-SHAPE	BANQUET ROUNDS	COCKTAIL ROUNDS	THEATER
Barnett Hall Ballroom (A&B)	W 73 x L 55	16	4,000	500	40	224	300	300
Barnett Hall A	W 36.5 x L 55	16	2,008	250	30	80	100	150
Barnett Hall B	W 36.5 x L 55	22	2,000	250	30	104	150	150
Barnett Foyer	W 19 x L 73	16	2,044	250	-	-	150	125
Barnett Music Room (A&B)	W 42 x L 23	14	966	112	28	48	75	70
Barnett Music Room A	W 21 x L 23	14	483	60	14	24	30	35
Barnett Music Room B	W 21 x L 23	14	483	60	14	24	30	35
Barnett Green Room (A&B)	W 42 x L 23	14	966	112	28	48	75	70
Barnett Green Room A	W 21 x L 23	14	483	60	14	24	30	35
Barnett Green Room B	W 21 x L 23	14	483	60	14	24	30	35
Barnett Dining Room	W 28 x L 21	14	690	50	15	40	35	40
Barnett Courtyard (1st Floor)	W 28 x L 22	-	616	50	-	40	40	16
2nd Floor Courtyard	-	-	1,500	100	28	48	100	100
High Five	-	-	2,500	120	-	-	-	-
Brutto Americano	-	20	4,000	120	-	-	-	-
Seaworthy 1st Floor	-	8	400	40	-	-	40	-
Seaworthy 2nd Floor - Section A	-	8	200	20	-	-	18	-
Seaworthy 2nd Floor - Section B	-	8	200	20	-	-	18	-
Seaworthy 3rd Floor	-	12	400	18	-	-	-	-
Seaworthy Courtyard	-	-	400	25	-	-	-	-

THE
BARNETT
NEW ORLEANS

CONTACT US TO BOOK YOUR EVENT OR FOR ADDITIONAL INFORMATION

600 CARONDELET STREET
NEW ORLEANS, LA 70130

MSYJD-GUEST.SERVICES@HYATT.COM
504.900.1180

THE
NEW ORLEANS
BARNETT

VI BRA NT

16,000 square feet of indoor and outdoor space awaits at The Barnett in New Orleans' Warehouse District. Historic charm blends with modern design and upgraded event technology throughout each of our venues, with each offering their own unique atmosphere—from our greenery-covered courtyard and garden rooftop to our original cobblestone reception area and performance-ready music rooms.

Plan your next meeting, special event or social gathering at The Barnett and join the chorus of New Orleans' vibrant song.



jd
v
BY HYATT™



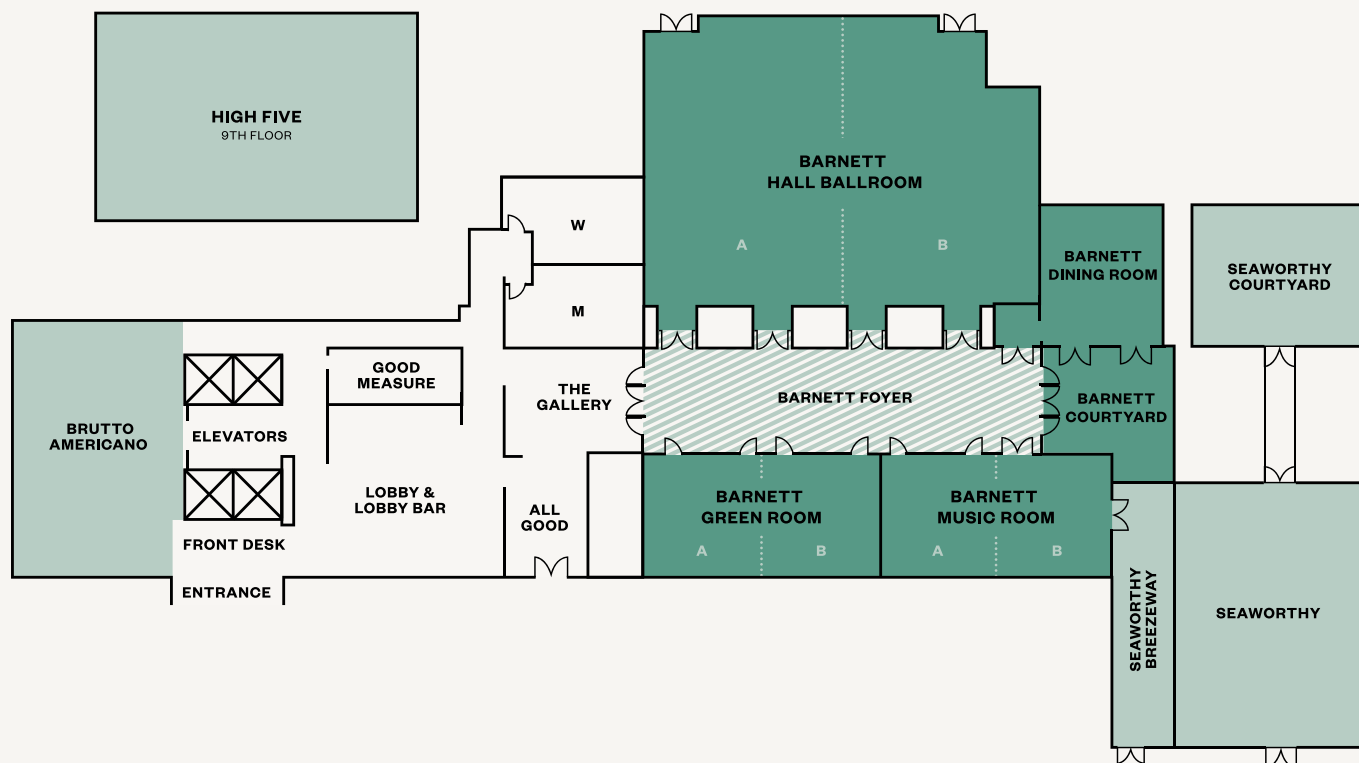

ROOM NAME	DIMENSIONS	CEILING HEIGHT	SQ FT	CAPACITY	U-SHAPE	BANQUET ROUNDS	COCKTAIL ROUNDS	THEATER
Barnett Hall Ballroom (A&B)	W 73 x L 55	16	4,000	500	40	224	300	300
Barnett Hall A	W 36.5 x L 55	16	2,008	250	30	80	100	150
Barnett Hall B	W 36.5 x L 55	22	2,000	250	30	104	150	150
Barnett Foyer	W 19 x L 73	16	2,044	250	-	-	150	125
Barnett Music Room (A&B)	W 42 x L 23	14	966	112	28	48	75	70
Barnett Music Room A	W 21 x L 23	14	483	60	14	24	30	35
Barnett Music Room B	W 21 x L 23	14	483	60	14	24	30	35
Barnett Green Room (A&B)	W 42 x L 23	14	966	112	28	48	75	70
Barnett Green Room A	W 21 x L 23	14	483	60	14	24	30	35
Barnett Green Room B	W 21 x L 23	14	483	60	14	24	30	35
Barnett Dining Room	W 28 x L 21	14	690	50	15	40	35	40
Barnett Courtyard (1st Floor)	W 28 x L 22	-	616	50	-	40	40	16
2nd Floor Courtyard	-	-	1,500	100	28	48	100	100
High Five	-	-	2,500	120	-	-	-	-
Brutto Americano	-	20	4,000	120	-	-	-	-
Seaworthy 1st Floor	-	8	400	40	-	-	40	-
Seaworthy 2nd Floor - Section A	-	8	200	20	-	-	18	-
Seaworthy 2nd Floor - Section B	-	8	200	20	-	-	18	-
Seaworthy 3rd Floor	-	12	400	18	-	-	-	-
Seaworthy Courtyard	-	-	400	25	-	-	-	-

THE
BARNETT

NEW
ORLEANS

CONTACT US TO BOOK YOUR EVENT OR FOR ADDITIONAL INFORMATION

600 CARONDELET STREET
NEW ORLEANS, LA 70130

MSYJD-GUEST.SERVICES@HYATT.COM
504.900.1180