

# 1<sup>ST</sup> FLOOR

# THE BARNETT NEW ORLEANS

600 Carondelet Street,  
New Orleans, LA 70130  
P. (504) 900-1180

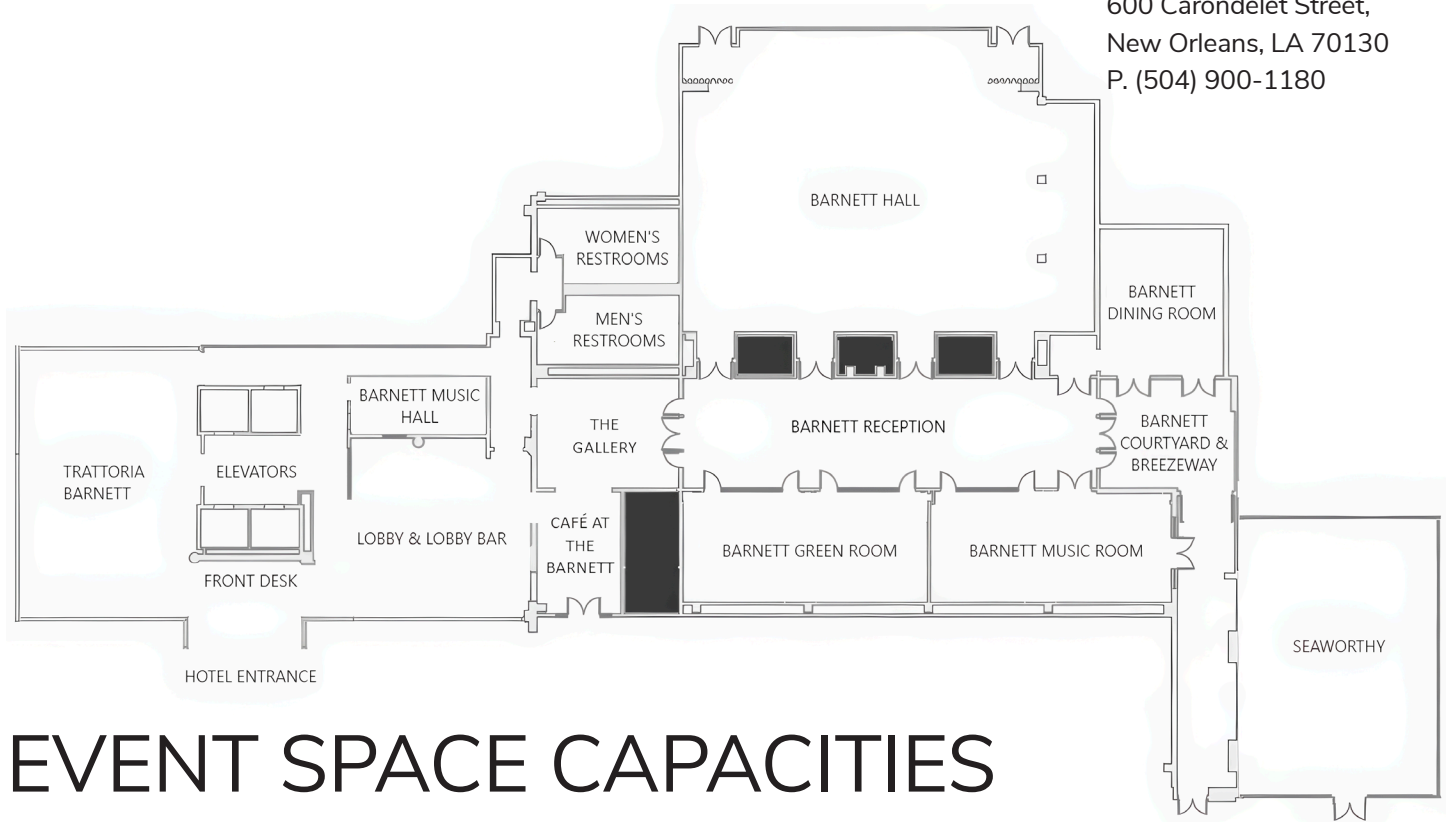

## EVENT SPACE CAPACITIES

| ROOM                       | Dimensions    | Boardroom | Classroom | Rounds | Reception | Theater | U-Shape |
|----------------------------|---------------|-----------|-----------|--------|-----------|---------|---------|
| <b>Barnett Hall</b>        | 4,000 sq. ft. | 40        | 350       | 275    | 400       | 500     | 50      |
| Barnett Hall A             | 2,000 sq. ft. | 30        | 175       | 150    | 200       | 250     | 30      |
| Barnett Hall B             | 2,000 sq. ft. | 20        | 175       | 150    | 200       | 250     | 30      |
| <b>Barnett Green Room</b>  | 960 sq. ft.   | 20        | 48        | 60     | 100       | 100     | 48      |
| Barnett Green Room A       | 480 sq. ft.   | 12        | 24        | 30     | 50        | 60      | 24      |
| Barnett Green Room B       | 480 sq. ft.   | 12        | 24        | 30     | 50        | 60      | 24      |
| <b>Barnett Music Room</b>  | 960 sq. ft.   | 20        | 48        | 60     | 100       | 100     | 48      |
| Barnett Music Room A       | 480 sq. ft.   | 12        | 24        | 30     | 50        | 60      | 24      |
| Barnett Green Room B       | 480 sq. ft.   | 12        | 24        | 30     | 50        | 60      | 24      |
| <b>Barnett Dining Room</b> | 675 sq. ft.   | 15        | 20        | 32     | 40        | 40      | 20      |
| <b>Barnett Foyer</b>       | 2,000 sq. ft. | -         | -         | -      | 150       | -       | -       |
| <b>Barnett Courtyard</b>   | 616 sq. ft.   | -         | -         | -      | 80        | -       | -       |
| <b>2nd Floor Courtyard</b> | 1,500 sq. ft. | -         | -         | 60     | 120       | -       | -       |