

THE BARNETT

NEW ORLEANS

POWERFUL

16,000 square feet of indoor and outdoor space awaits at The Barnett in New Orleans' Warehouse District. Historic charm blends with modern design and upgraded event technology throughout each of our venues, with each offering their own unique atmosphere—from our greenery-covered courtyard and garden rooftop to our original cobblestone reception area and performance-ready music rooms.

Plan your next meeting, special event or social gathering at The Barnett and join the chorus of New Orleans' vibrant song.



jd
v
BY HYATT™



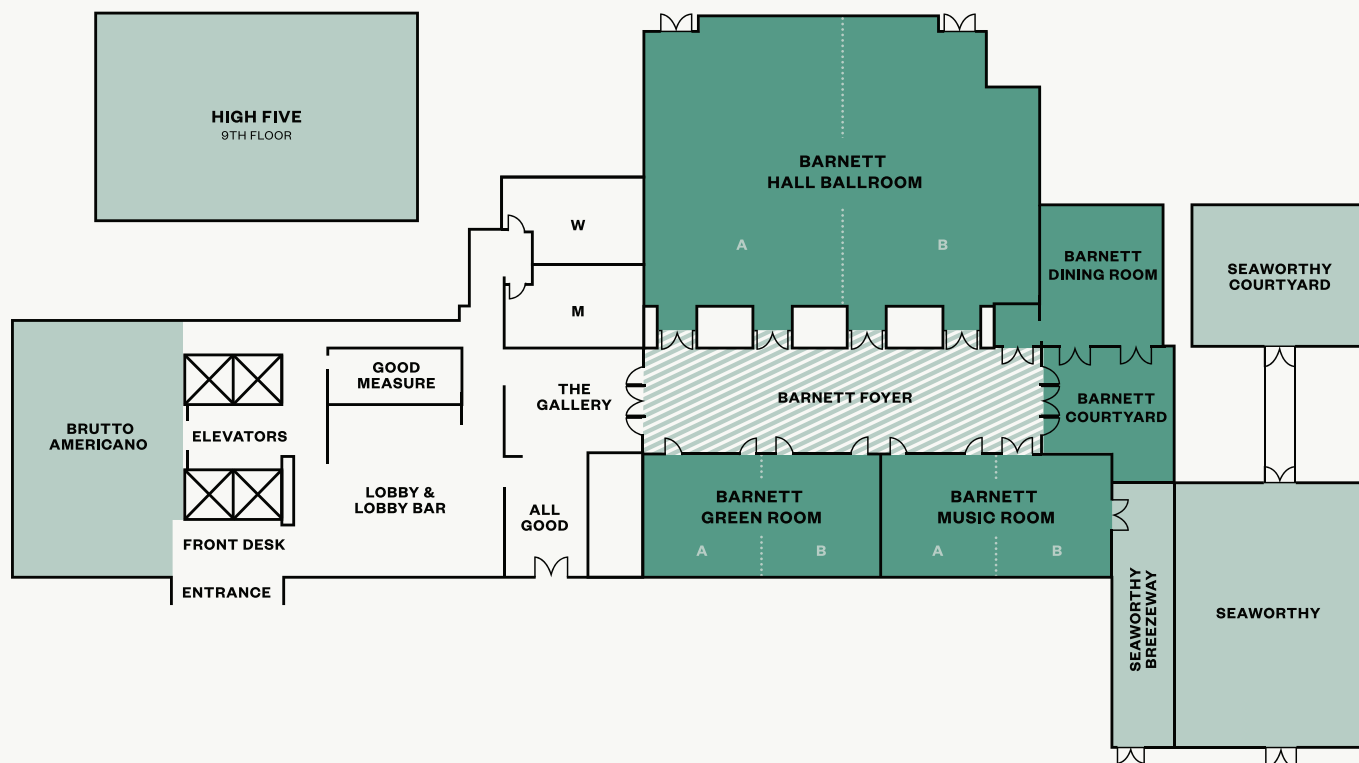

| ROOM NAME | DIMENSIONS | CEILING HEIGHT | SQ FT | CLASSROOM | U-SHAPE | BANQUET ROUNDS | COCKTAIL ROUNDS | THEATER |
|---------------------------------|---------------|----------------|-------|-----------|---------|----------------|-----------------|---------|
| Barnett Hall Ballroom (A&B) | W 73 x L 55 | 16 | 4,000 | 360 | 50 | 224 | 300 | 300 |
| Barnett Hall A | W 36.5 x L 55 | 16 | 2,008 | 180 | 30 | 80 | 100 | 150 |
| Barnett Hall B | W 36.5 x L 55 | 22 | 2,000 | 180 | 30 | 104 | 150 | 150 |
| Barnett Foyer | W 19 x L 73 | 16 | 2,044 | - | - | - | 150 | 125 |
| Barnett Music Room (A&B) | W 42 x L 23 | 14 | 966 | 48 | 48 | 48 | 75 | 70 |
| Barnett Music Room A | W 21 x L 23 | 14 | 483 | 24 | 20 | 24 | 30 | 35 |
| Barnett Music Room B | W 21 x L 23 | 14 | 483 | 24 | 20 | 24 | 30 | 35 |
| Barnett Green Room (A&B) | W 42 x L 23 | 14 | 966 | 48 | 48 | 48 | 75 | 70 |
| Barnett Green Room A | W 21 x L 23 | 14 | 483 | 24 | 24 | 24 | 30 | 35 |
| Barnett Green Room B | W 21 x L 23 | 14 | 483 | 24 | 24 | 24 | 30 | 35 |
| Barnett Dining Room | W 28 x L 21 | 14 | 690 | 20 | 20 | 40 | 35 | 40 |
| Barnett Courtyard (1st Floor) | W 28 x L 22 | - | 616 | - | - | 40 | 40 | 16 |
| 2nd Floor Courtyard | - | - | 1,500 | - | 28 | 48 | 100 | 100 |
| High Five | - | - | 2,500 | - | - | - | - | - |
| Brutto Americano | - | 20 | 4,000 | - | - | - | - | - |
| Seaworthy 1st Floor | - | 8 | 400 | - | - | - | 40 | - |
| Seaworthy 2nd Floor - Section A | - | 8 | 200 | - | - | - | 18 | - |
| Seaworthy 2nd Floor - Section B | - | 8 | 200 | - | - | - | 18 | - |
| Seaworthy 3rd Floor | - | 12 | 400 | - | - | - | - | - |
| Seaworthy Courtyard | - | - | 400 | - | - | - | - | - |

THE
BARNETT

NEW
ORLEANS

CONTACT US TO BOOK YOUR EVENT OR FOR ADDITIONAL INFORMATION

600 CARONDELET STREET
NEW ORLEANS, LA 70130

MSYJD-GUEST.SERVICES@HYATT.COM
504.900.1180

THE
NEW ORLEANS
BARNETT

VIBRANT

16,000 square feet of indoor and outdoor space awaits at The Barnett in New Orleans' Warehouse District. Historic charm blends with modern design and upgraded event technology throughout each of our venues, with each offering their own unique atmosphere—from our greenery-covered courtyard and garden rooftop to our original cobblestone reception area and performance-ready music rooms.

Plan your next meeting, special event or social gathering at The Barnett and join the chorus of New Orleans' vibrant song.



jd
v
BY HYATT™



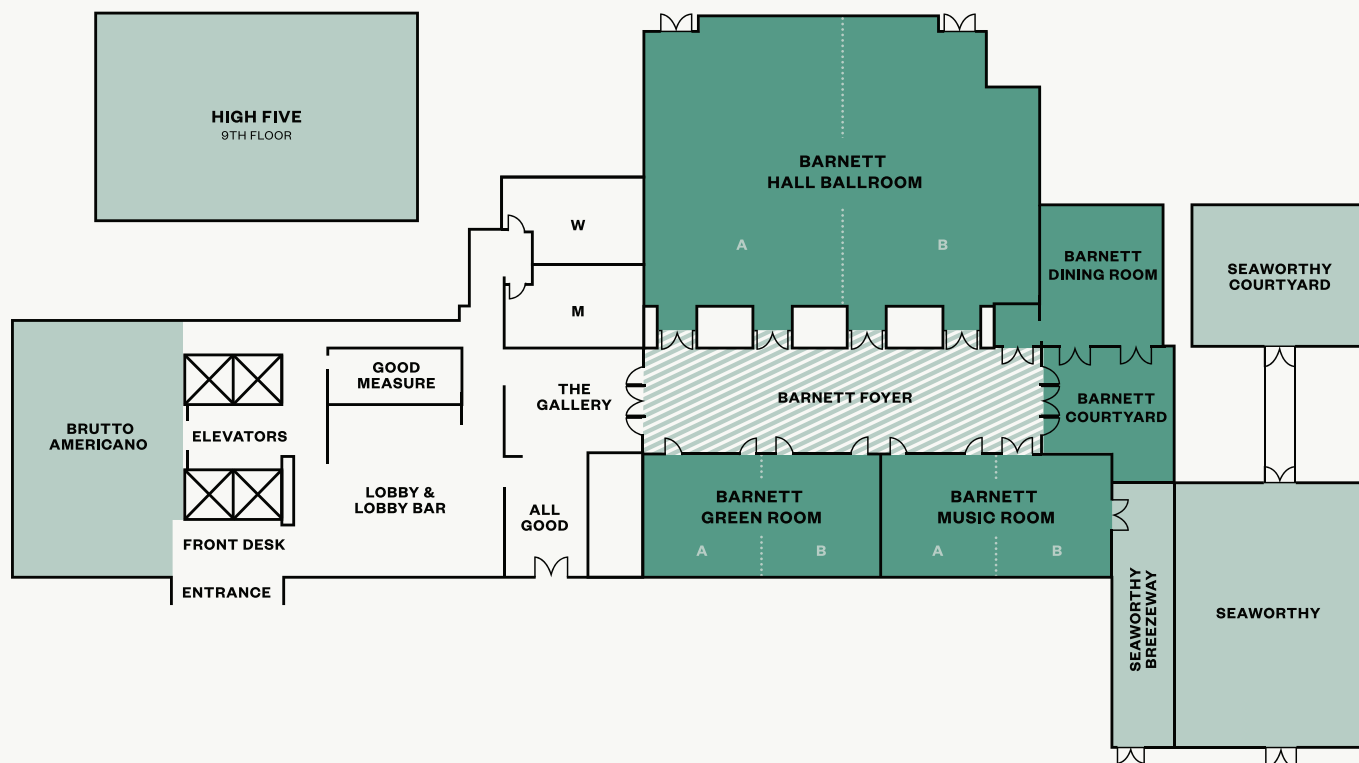

| ROOM NAME | DIMENSIONS | CEILING HEIGHT | SQ FT | CAPACITY | U-SHAPE | BANQUET ROUNDS | COCKTAIL ROUNDS | THEATER |
|---------------------------------|---------------|----------------|-------|----------|---------|----------------|-----------------|---------|
| Barnett Hall Ballroom (A&B) | W 73 x L 55 | 16 | 4,000 | 500 | 50 | 224 | 300 | 300 |
| Barnett Hall A | W 36.5 x L 55 | 16 | 2,008 | 250 | 30 | 80 | 100 | 150 |
| Barnett Hall B | W 36.5 x L 55 | 22 | 2,000 | 250 | 30 | 104 | 150 | 150 |
| Barnett Foyer | W 19 x L 73 | 16 | 2,044 | 250 | - | - | 150 | 125 |
| Barnett Music Room (A&B) | W 42 x L 23 | 14 | 966 | 112 | 48 | 48 | 75 | 70 |
| Barnett Music Room A | W 21 x L 23 | 14 | 483 | 60 | 20 | 24 | 30 | 35 |
| Barnett Music Room B | W 21 x L 23 | 14 | 483 | 60 | 20 | 24 | 30 | 35 |
| Barnett Green Room (A&B) | W 42 x L 23 | 14 | 966 | 112 | 48 | 48 | 75 | 70 |
| Barnett Green Room A | W 21 x L 23 | 14 | 483 | 60 | 24 | 24 | 30 | 35 |
| Barnett Green Room B | W 21 x L 23 | 14 | 483 | 60 | 24 | 24 | 30 | 35 |
| Barnett Dining Room | W 28 x L 21 | 14 | 690 | 50 | 20 | 40 | 35 | 40 |
| Barnett Courtyard (1st Floor) | W 28 x L 22 | - | 616 | 50 | - | 40 | 40 | 16 |
| 2nd Floor Courtyard | - | - | 1,500 | 100 | 28 | 48 | 100 | 100 |
| High Five | - | - | 2,500 | 120 | - | - | - | - |
| Brutto Americano | - | 20 | 4,000 | 120 | - | - | - | - |
| Seaworthy 1st Floor | - | 8 | 400 | 40 | - | - | 40 | - |
| Seaworthy 2nd Floor - Section A | - | 8 | 200 | 20 | - | - | 18 | - |
| Seaworthy 2nd Floor - Section B | - | 8 | 200 | 20 | - | - | 18 | - |
| Seaworthy 3rd Floor | - | 12 | 400 | 18 | - | - | - | - |
| Seaworthy Courtyard | - | - | 400 | 25 | - | - | - | - |

THE
BARNETT
NEW ORLEANS

CONTACT US TO BOOK YOUR EVENT OR FOR ADDITIONAL INFORMATION

600 CARONDELET STREET
NEW ORLEANS, LA 70130

MSYJD-GUEST.SERVICES@HYATT.COM
504.900.1180